

# MDF-U5412

## Features

Panasonic MDF-U5412 provides an ideal freezing environment for preservation of blood plasma, vaccines, test samples, and other biological specimens.

### Stable & Uniform Temperature Design

- Double outer doors
- Full-height storage containers on each shelf
- Cooling tubes under every shelf
- Direct cooling system for stable temperature control
- Fine-controllable refrigeration circuit with valve

### Large Storage Capacity

- 300ml FFP\* bag x 280 pieces.  
\*Fresh Frozen Plasma

### User Friendly Design

- Built-in door latch for each door
- Easy calibration through the control panel

### Visual and Audible Alarm System

- High & Low temperature alarm
- Power failure alarm with non-volatile memory back up
- Self-diagnostic system

### Safety Function

- Remote alarm contact
- Re-activating buzzer, lamp and remote alarm contact (30min.after buzzer stops)
- Standard door lock and independent padlock hasp door latches for extra security
- Remote monitoring by Data acquisition system (Option)
- 1/7/30 days circular recorder (Option)

### Environment friendly

- HCFC-Free refrigerant and insulation

## Specifications

Model No.	MDF-U5412
Exterior Dimensions (W x D x H)	804 x 772 x 1802 (mm) / 31.7 x 30.4 x 71.0 (inch)
Interior Dimensions (W x D x H)	658 x 607 x 1272 (mm) / 25.9 x 23.9 x 50.1 (inch)
Net weight	131kg (288.8 lbs.)
Effective capacity	482 liters (17.0 cu.ft.)
Exterior cabinet	Galvanised steel with baked-on finish
Cabinet insulation	Rigid polyurethane foamed-in place
Outer door	2, Insulated and magnetic sealed
Door lock	1 door lock, 2 lockable door latches for each door
Storage container	6 pcs. (Upper room), 4 pcs. (Lower room)
Casters	4
Adjustable leveling feet	2
Compressor	400W Hermetically sealed
Refrigerant	HFC refrigerant
Temp. control range	-20°C to -40°C (Ambient temperature 5°C to 30°C)
Settable range	-18°C to -45°C
Cooling method	Direct cooling
Temperature control	Microprocessor control
Temperature alarm	High/Low (±5 to ±15°C, adjustable)
Power failure alarm	Buzzer and lamp (Automatic rechargeable battery), Memory back up
Remote alarm contact	Allowable contact capacity: DC30V, 2A, Temperature alarm or power failure alarm
Access hole	ø30, Rear side
Accessories	Door lock key, Defrost spatula, Storage containers

### Options

Panasonic data acquisition software (MTR-5000-PW)  
 Ethernet (LAN) Interface (MTR-L03-PW), RS232C/RS485 Interface (MTR-480-PW)  
 Strip chart recorder (MTR-4015LH-PE)  
 Recorder mounting kit (MPR-S30-PW), Recording paper (RP-40-PW)  
 Circular chart recorder (MTR-G85C-PE)  
 Recorder mounting kit (MPR-S7-PW), Recording paper (RP-G85-PW), Recording pen (PG-R-PW)

### Voltage specification by destination

Representative destination	Voltage	Frequency	Model
Europe	230V	50Hz (CE)	MDF-U5412-PE
Korea	220V	60Hz	MDF-U5412-PK
Thailand	220V	50Hz	MDF-U5412-PB

Caution: Panasonic guarantees the product under certain warranty conditions. Panasonic in no way shall be responsible for any loss of content or damage to content.

• Appearance and specifications are subject to change without notice.

## Performance Data

### Pull-down characteristics

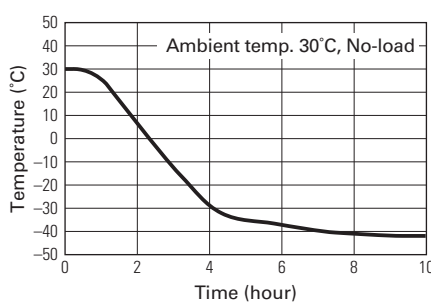

### Pull-up characteristics during power failure

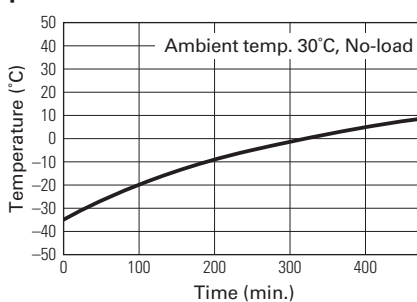

## Dimensions

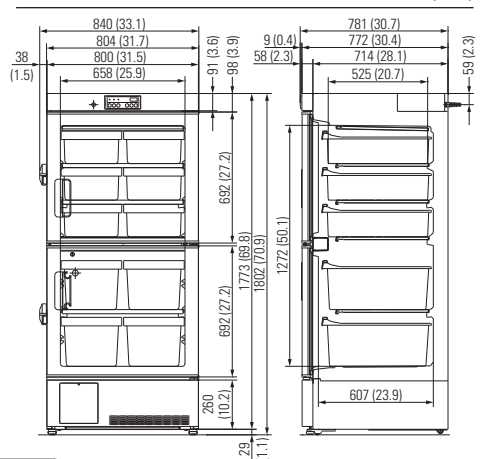

Panasonic Healthcare Co., Ltd., Gunma Factory is certified for:  
**Quality management system: ISO9001**  
**Medical devices quality management system: ISO13485**



Panasonic Healthcare Co., Ltd., Gunma Factory is certified for:  
**Environmental management system: ISO14001**

## DISTRIBUTED BY:



**PT. SIGMA BIMED**  
**Indonesia Sole Distributor**

Jl. Agung Utara Raya Blok A 36D/42 Sunter Agung Jakarta Utara 14350 Indonesia

Telp. (62-21) 64716568, 70240088, 70240099, 87960123, 87960456

Fax. (62-21) 64716566, 87961123, 87961456

Email : sigmabimed@indo.net.id, sales@sigmabimed.com

Website : www.sigmabimed.com  
 kemenkes RI AKL

**Panasonic®**

Panasonic Healthcare., Ltd.

1-1-1 Sakata, Oizumi-Machi, Ora-Gun, Gunma 370-0596, Japan  
 ©Panasonic Healthcare Co., Ltd. 2012

Preservation  
sub-zero



MDF-U5412

### Temperature

(Ambient temperature 30°C)

**-40°C**

### Effective capacity

**482 liters/17.0 cu.ft.**

**280 pcs**

300ml frozen plasma bag

### Biomedical Freezer for reliable preservation of blood plasma and other biologics

- High freezing power
- Stable & Uniform temperature design
- Ideal freezing environment for biologicals
- Alarm and safety devices